

Balcony Detail

VaproShield membrane installed with minimum 3" overlap over Balconyguard

[For complete Balconyguard installation instructions, click here.](#)

VaproShield membrane installed with minimum 3" overlap at seams

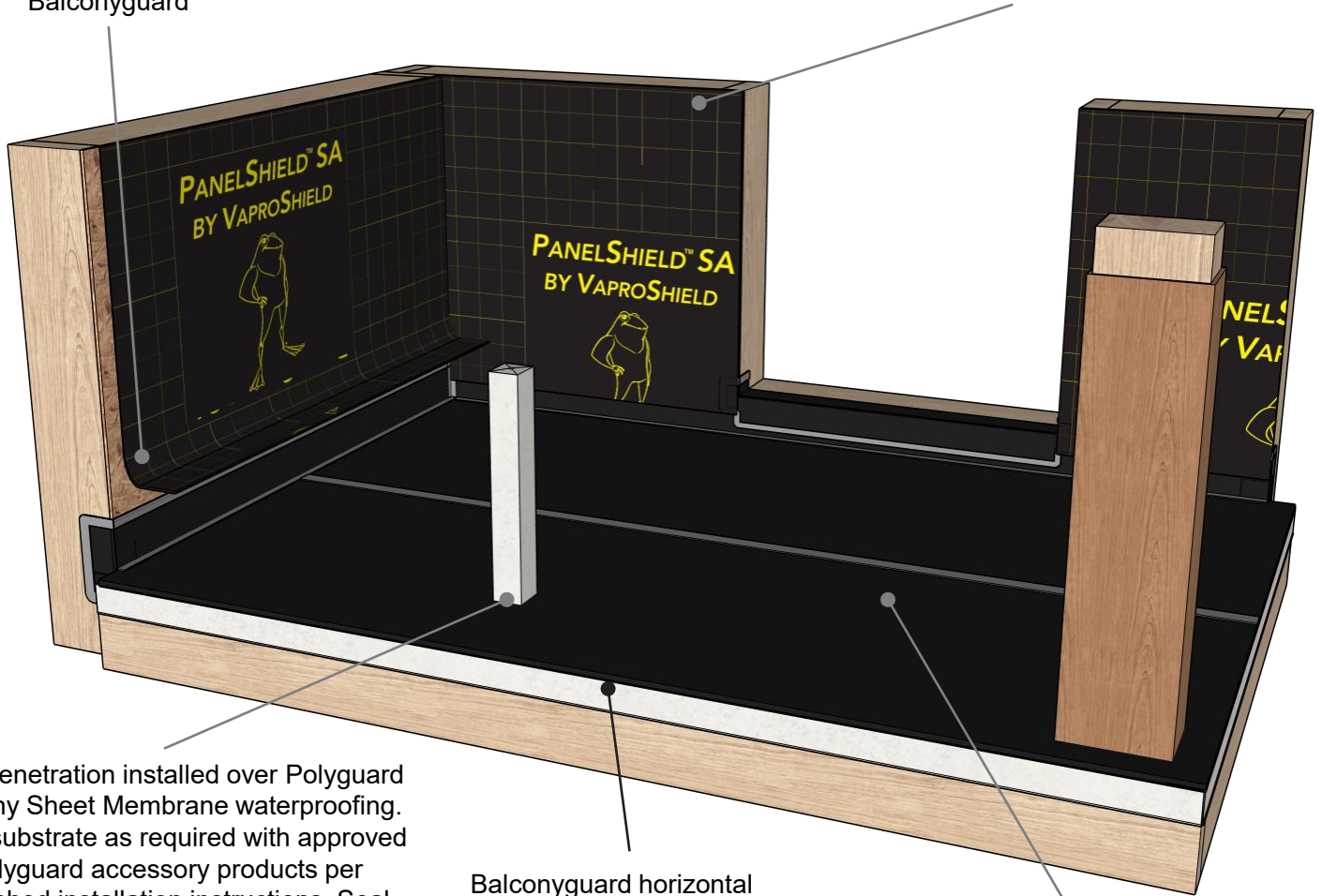

Post penetration installed over Polyguard Balconyguard Sheet Membrane waterproofing. Treat substrate as required with approved Polyguard accessory products per published installation instructions. Seal top of post attachment with Polyguard Detail Sealant PW or LM-95

Balconyguard horizontal and Drip Edges installed around edge, secured with fasteners

Substrate is primed, and Balconyguard Membrane is installed with proper flashing. Seal all edges and terminations with Polyguard Detail Sealant PW or LM-95.

Note: Polyguard Balconyguard Membrane may be replaced with Polyguard 650 Membrane or Polyguard 650 PRM.



PRODUCT DESCRIPTION

*This detail is compatible with all VaproShield self-adhered WRB/AB sheet membranes. The appropriate VaproShield WRB/AB product shall be selected based on project-specific requirements.

DISCLAIMER

Detail sketch is generic, representing suggested best practices for VaproShield materials, and does not represent a specific job site condition and therefore may not be applicable to certain projects. Detail sketch is designed for use as a reference and must be approved by the designer/consultant of record for each project prior to installation by the subcontractor. Changes and approvals of VaproShield details are the sole responsibility of the designer/consultant of record. VaproShield is **not** the designer of record for building enclosure details and takes no responsibility for the accuracy or interpretation of actual project site conditions.

DRAWN BY: AR

DATE: 4/22/26

REF: 362